



AVENIDA MAR MEDITERRANEO SAN PEDRO DE
ALCÁNTARA MARBELLA

€985,000

150 Years
JOHN D WOOD & CO.

London, Country & International Property

AVENIDA MAR MEDITERRANEO SAN PEDRO DE ALCÁNTARA MARBELLA

We present you a new standard in lifestyle in our unbeatable new project, carefully designed to give you the best in comfort, functionality and location. Salvia is strategically located in the heart of San Pedro, ensuring that everything you need is just a few steps away. From supermarkets, shops to pharmacies and medical services, as well as one of the best tennis and paddle clubs in the area, golf courses, restaurants and beach clubs. The apartments will be built with top quality materials and open-plan and bright living areas.

Garage

€985,000

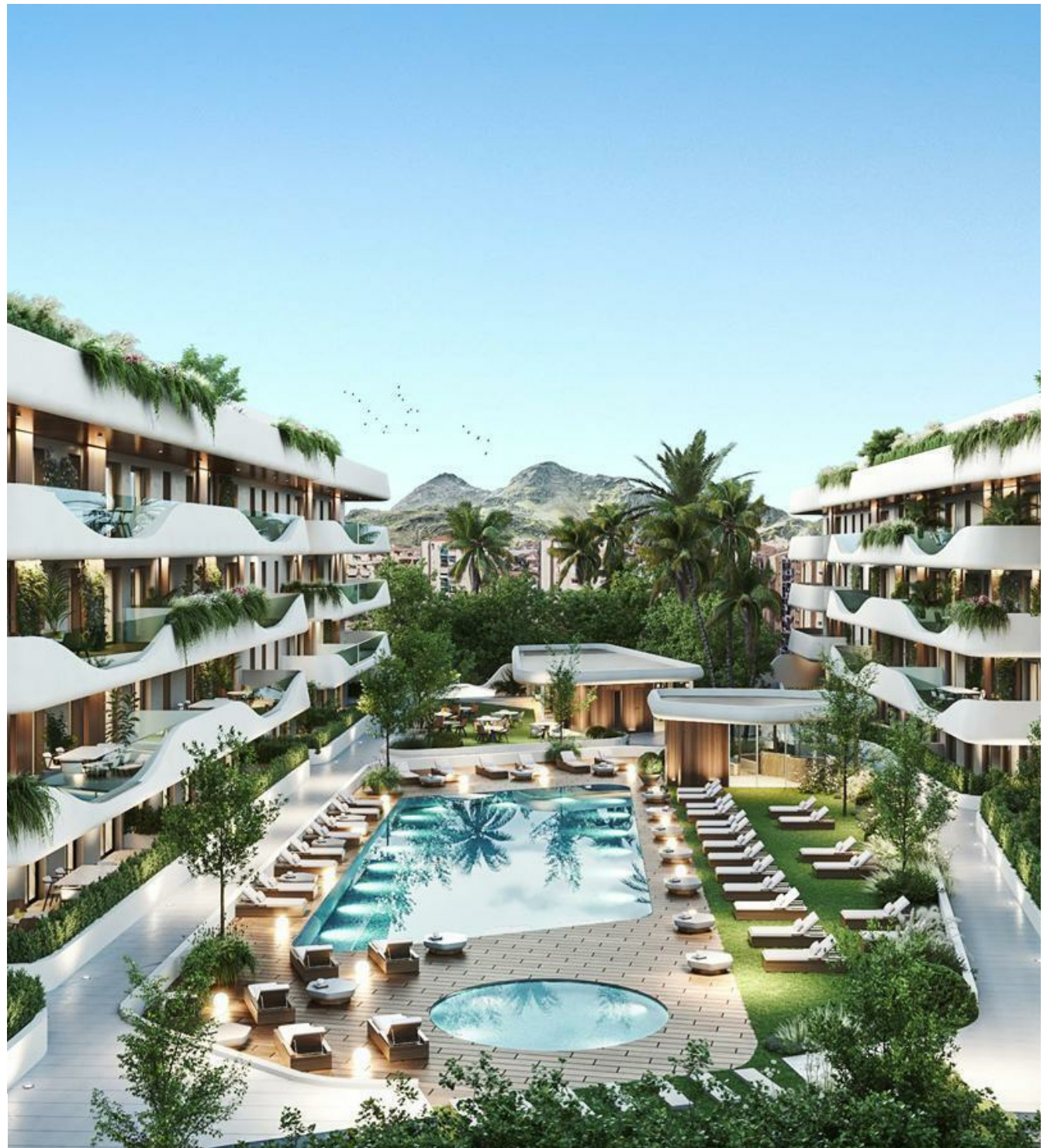

From 2, 3 and 4 bedroom apartments and penthouses, with spacious interiors of up to 195 m² and fabulous terraces of up to 189 m², each apartment is a testament to contemporary design and elegance. All homes will have at least one parking space and storage room included in the price and all apartments are customizable to the buyer's taste. Our communal areas are no less impressive, you will be able to immerse yourself in state-of-the-art facilities such as a dedicated Co-working space for the modern professional, electric vehicle charging points for the most environmentally conscious clients, a heated indoor pool and a fully equipped gym and spa. The complex will be fully gated, with a security entrance and control gate. In short, SALVIA stands out as the best project in the area due to its unique and avant-garde design that combines aesthetics and functionality in an exceptional way. Join us and experience a new level of unbeatable living! #ref:CBSH142_A



